



**LG**

website <http://www.lgservice.com>

LG

**LG**

**PI485 GATEWAY**

***INSTALLATION MANUAL***

**Models: PHNFP14A0  
PSNFP14A0**

**IMPORTANT**

- Please read this installation manual completely before installing the product.
- Installation work must be performed in accordance with the national wiring standards by authorized personnel only.
- Please retain this installation manual for future reference after reading it thoroughly.

# TABLE OF CONTENTS

■ Part Installation & Operation precution .....	3~4
■ Part Description .....	5
■ Installation Guide .....	7
■ Installation Steps .....	7
■ DIP Switch Configuration.....	8
■ Simple Central Controller - Connection Diagram .....	10
■ Deluxe Central Controller - Connection Diagram .....	12
■ Examples For Product Installation.....	13
■ Accessory Parts .....	14

# Safety Precautions



To prevent injury to the user or other people and property damage, the following instructions must be followed.

- Incorrect operation due to ignoring instruction will cause harm or damage. The seriousness is classified by the following indications.

**⚠ WARNING** This symbol indicates the possibility of death or serious injury.

**⚠ CAUTION** This symbol indicates the possibility of injury or damage.

- Meanings of symbols used in this manual are as shown below.

	<b>Be sure not to do.</b>
	<b>Be sure to follow the instruction.</b>

## ⚠ WARNING

### ■ Installation

**Don't touch with the hands while the power is on**

- There is risk of fire or electric shock.

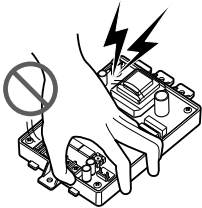

**Use standard parts(connector).**

- Do not disassemble or repair the product. There is risk of fire or electric shock.

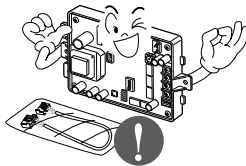

**For electrical work, contact the dealer, seller, a qualified electrician, or an Authorized Service Center.**

- Do not disassemble or repair the product. There is risk of fire or electric shock.



**Use the correctly rated breaker or fuse.**

- There is risk of fire or electric shock.

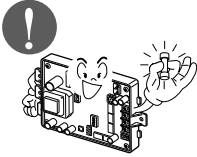

**Do not install, remove, or re-install the unit by yourself (customer).**

- There is risk of fire, electric shock, explosion, or injury.

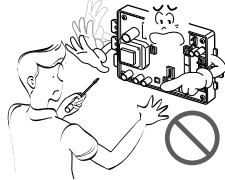

**For installation, always contact the dealer or an Authorized Service Center.**

- There is risk of fire, electric shock, explosion, or injury.

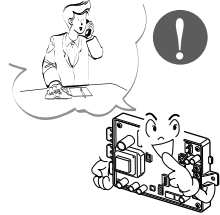

---

## ■ Operation

**When the product is soaked (flooded or submerged), contact an Authorized Service Center.**

- There is risk of fire or electric shock.

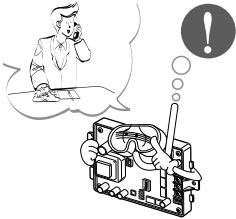

**Be cautious that water could not enter the product.**

- There is risk of fire, electric shock, or product damage.

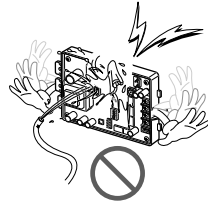

# Part Description

## PHNFP14A0

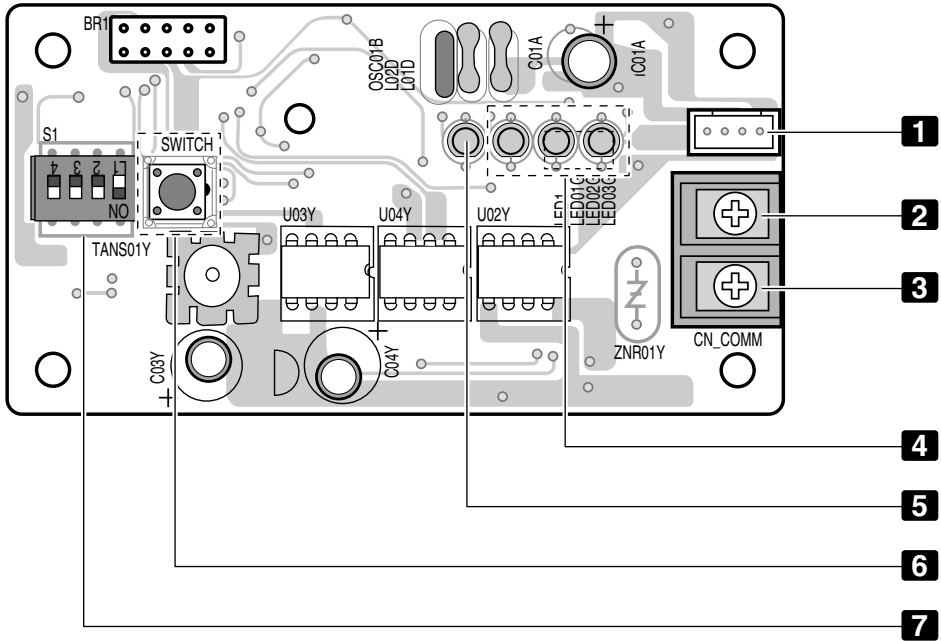

### PI485 GATEWAY(C)

- 1** CN\_OUT: Indoor Unit Connector
- 2** BUS\_B: RS-485 (-) Terminal
- 3** BUS\_A: RS-485 (+) Terminal
- 4** LED01G,02G,03G: Communication Status LED
- 5** LED1: RS-485 Communication Status LED
- 6** Reset Switch: PI485(C) Reset
- 7** DIP Switch: Product Select (Refer Page 8)

# PSNFP14A0

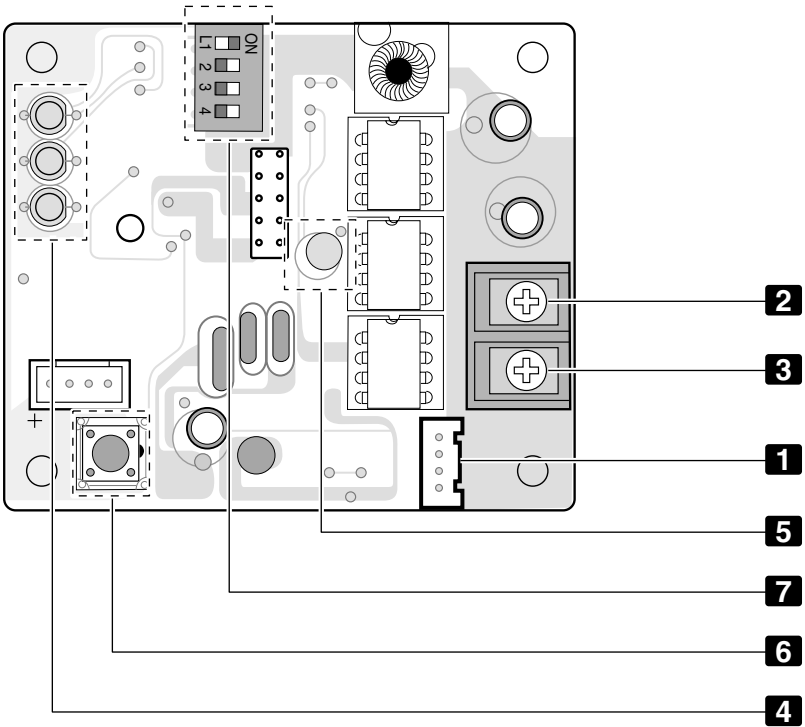

## PI485 GATEWAY(R)

- 1** CN\_OUT: Indoor Unit Connector
- 2** BUS\_A: RS-485 (+) Terminal
- 3** BUS\_B: RS-485 (-) Terminal
- 4** LED01G,02G,03G: Communication Status LED
- 5** LED1: RS-485 Communication Status LED
- 6** Reset Switch: PI485(C) Reset
- 7** DIP Switch: Product Select (Refer Page 9)

# Installation Guide

## Installation Steps (PHNFP14A0/PSNFP14A0)

1. **7** Select DIP Switch Configuration(Refer page 8 or 9)
2. **2 3** Connect The RS-485 BUS\_A(+), BUS\_B(-) with Other Network Products (ex, Simple Central Controller , CNU.....)
3. **1** Connect CN\_OUT with Outdoor Unit by the cable (provided)
4. **4** Check the Communication Status LED
  - LED01G(Red): Ok operation-LED blinks for 5times and is OFF.  
This process is repeated after every 3 minutes
    - NG operation : Check The Indoor unit address & Wiring Connections
  - LED02G(Yellow) ,LED03G(Orange): Ok operation-LED's blinks continuously
    - NG operation : Check The DIP Switch setting & Wiring Connections
5. **5** Check the RS-485 Communication Status LED:
  - Ok operation
    - (1) LED's blinks 2 Times in every 10~30 seconds (In case Connected CNU)
    - (2) LED's blinks continuously (In case Connected Simple Central Controller)
  - NG operation : Check The Wiring Connections
6. Finally if all the above steps are OK then , Tie the cables by Tie Wraps & Clamp

# DIP Switch Configuration

## • PHNFP14A0

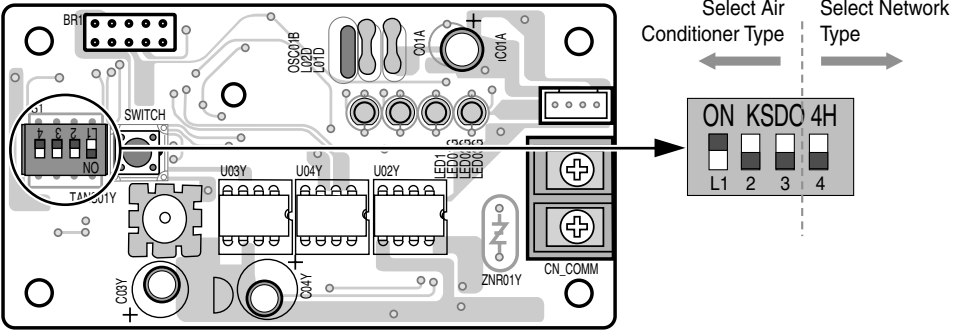

Using LGAP CAC/RAC/SRAC/PAC Products Configuration Methods

 → 3 ON+ALL OFF: Using LGAP CAC/RAC/SRAC/PAC Products Configuration Methods

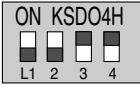
 → 3, 4 ON+ALL OFF: LGAP CAC/RAC/SRAC/PAC Products + Central Controller (ALL type)-Using LGAP

**CAUTION:**  
Wrong Products Configuration can lead to malfunctioning



• PSNFP14A0

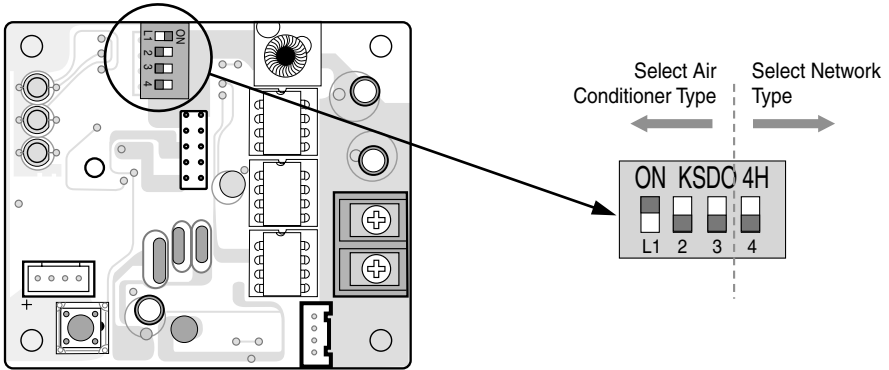

Using LGAP CAC/RAC/SRAC/PAC Products Configuration Methods



➔ 3 ON+ALL OFF: LGAP CAC/RAC/SRAC/PAC Products + Central Controller (ALL type)-Without LGAP

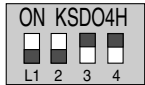

➔ 3, 4 ON+ALL OFF: LGAP CAC/RAC/SRAC/PAC Products + Central Controller (ALL type)-Using LGAP



**CAUTION:**

Wrong Products Configuration can lead to malfunctioning

## Simple Central Controller - Connection Diagram

### • PHNFP14A0

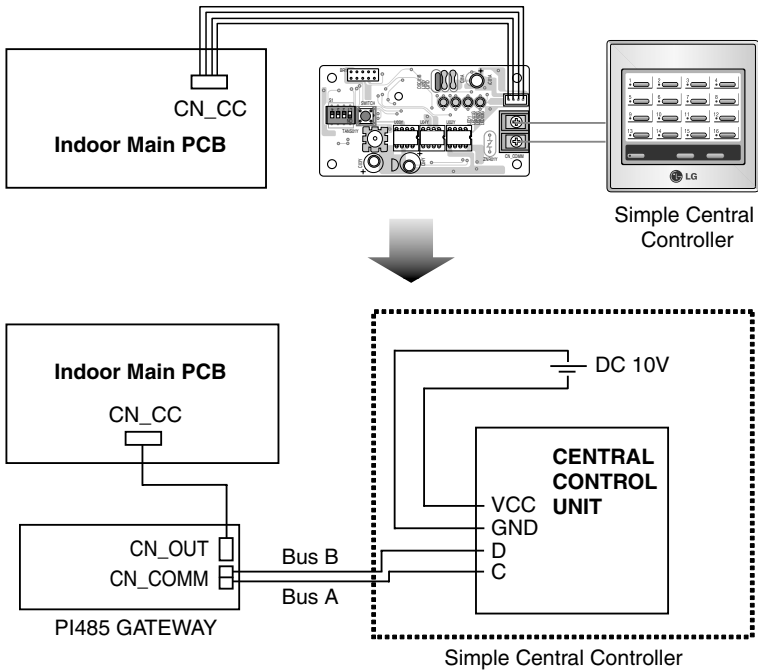

**CAUTION:**

After Product Installation Tie the cables with the clamps & Tie-Wraps provided.

• PSNFP14A0

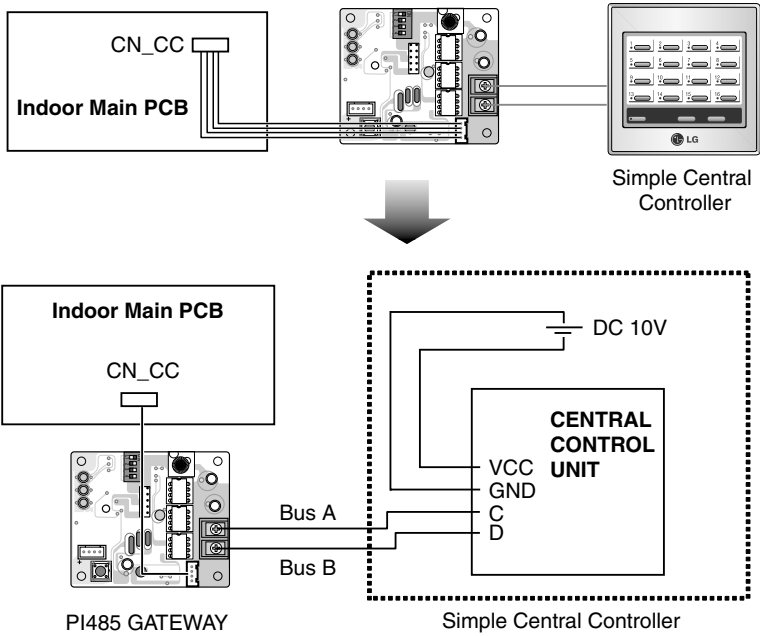

**CAUTION:**

After Product Installation Tie the cables with the clamps & Tie-Wraps provided.

## Deluxe Central Controller - Connection Diagram

### • PHNFP14A0

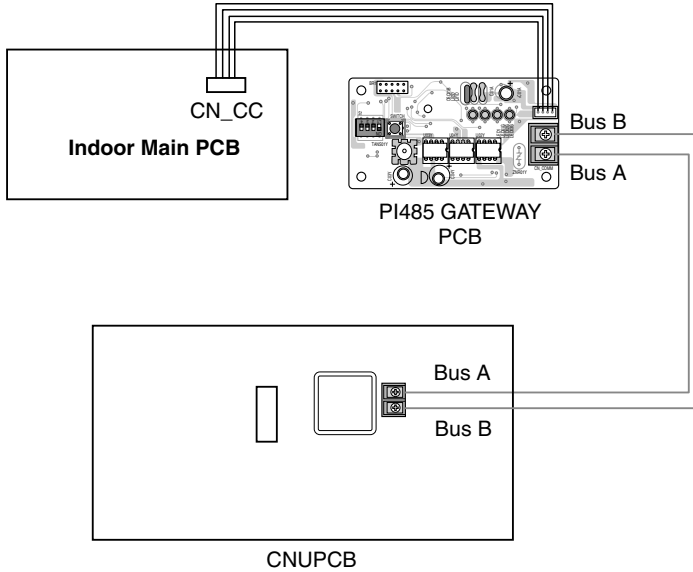

### • PSNFP14A0

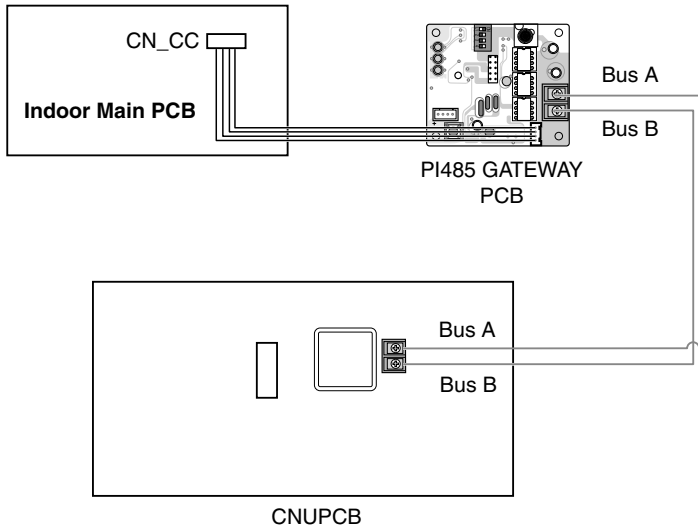

**CAUTION:** After Product Installation Tie the cables with the clamps & Tie-Wraps provided.

## Examples For Product Installation

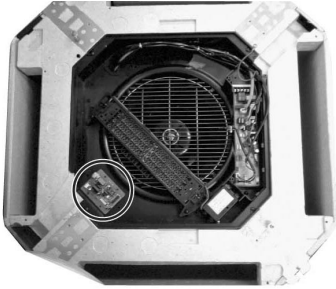

(1) The Installation for 4Way Cassette Product

→ Check Screw boss for PCB in 4way Cassette Product Then fix It

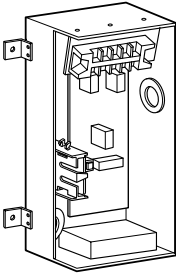

(2) The Installation for DUCT Product

→ Using PCB Holder provided

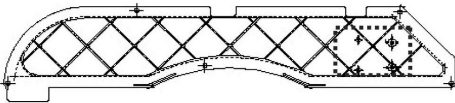

(3) The Installation for Cassette Product Cover

→ Check Screw boss for PCB in 4way Cassette Product Then fix It



**CAUTION:**

It can be Different location of installation in order to Each Product structure

# Accessory Parts

## • PHNFP14A0

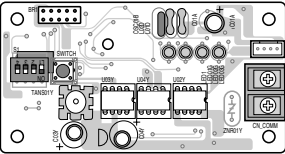
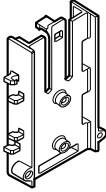
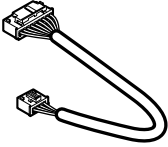
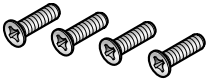
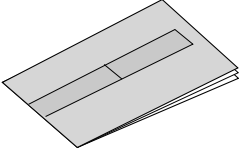
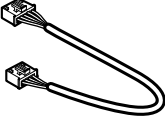
		
<p>PCB :6871A20484B</p>	<p>Holder for DUCT :3110A 20056A</p>	<p>WIRE ASSY 1(for RAC/SRAC/CAC)</p>
		
<p>Screw 4 EA</p>	<p>Installation Manual</p>	<p>WIRE ASSY(for Others)</p>

## • PSNFP14A0

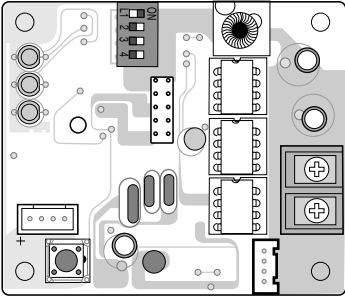
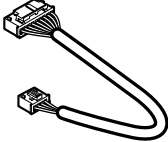
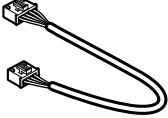
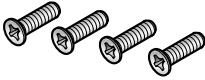
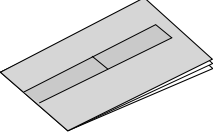
		
	<p>WIRE ASSY 1(for RAC/SRAC/CAC)</p>	<p>WIRE ASSY(for Others)</p>
	<p>Screw 4 EA</p>	
<p>PCB :6871A20484C</p>	<p>Screw 4 EA</p>	<p>Installation Manual</p>

\* **Others** : Tie Wrap (3 EA) - Cable Tie  
Clamp (1 EA)

